



# AUDION

## Packaging Machines

*Together we make the perfect package*

### **Power Sealer TC**

**Temperature Controlled  
(Vacuum) Impulse Sealer**

**(VAC) PSR TC**

**Equipped with:  
Audion Touch Techware  
Version PS7.08.04**

**Technical  
Specification Sheet**

Rev.02

General specifications			
Type of machine	Temperature controlled impulse sealer (PSR TC) Temperature controlled vacuum impulse sealer (VAC PSR TC)		
Models	(VAC) PSR TC 520	(VAC) PSR TC 720	(VAC) PSR TC 1020
Machine dimensions WxDxH	615 x 512 x 257 mm	815 x 512 x 257 mm	1115 x 512 x 257 mm
Weight	41 kg	46 kg	50 kg
Seal length	520 mm	720 mm	1020 mm
Seal width	8 mm		
Seal system	Bi-active seal, flat seal		
Control system	Audion Touch Techware Equipped with Audion Temperature Controller (ATC) + 7 inch touchscreen (ADC)		
Data transfer	USB		
Operation	Foot pedal, emergency switch		
Vacuum system (*)	SMC Venturi pump 11.3 m3/h (240 L/min. at 6 bar)		
Covering	Stainless steel		
Power supply	115 V – 1ph – 50/60Hz 230 V – 1ph – 50/60Hz		
Power consumption	2500 W	3000 W	2600 W
Pneumatic supply	0.6 MPa (min) – 1.0 MPa (max)		
Gas supply (*)	Max. 0.1 MPa		
Noise level	≤ 85 (dB(A))		

(\*) Only applicable to vacuum models

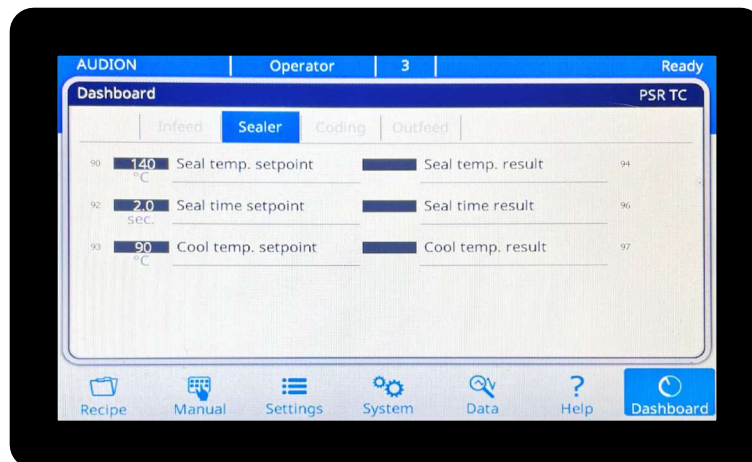
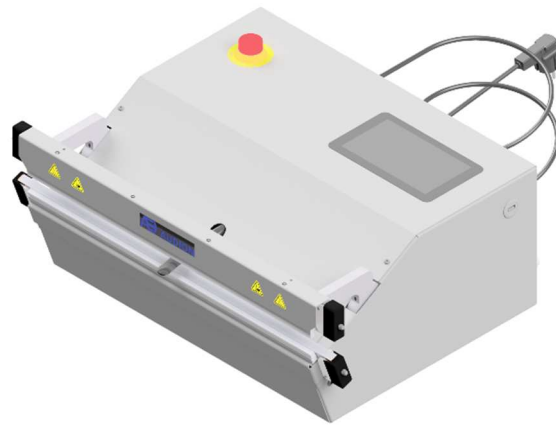

PSR TC

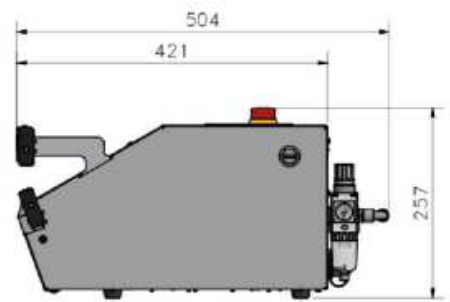
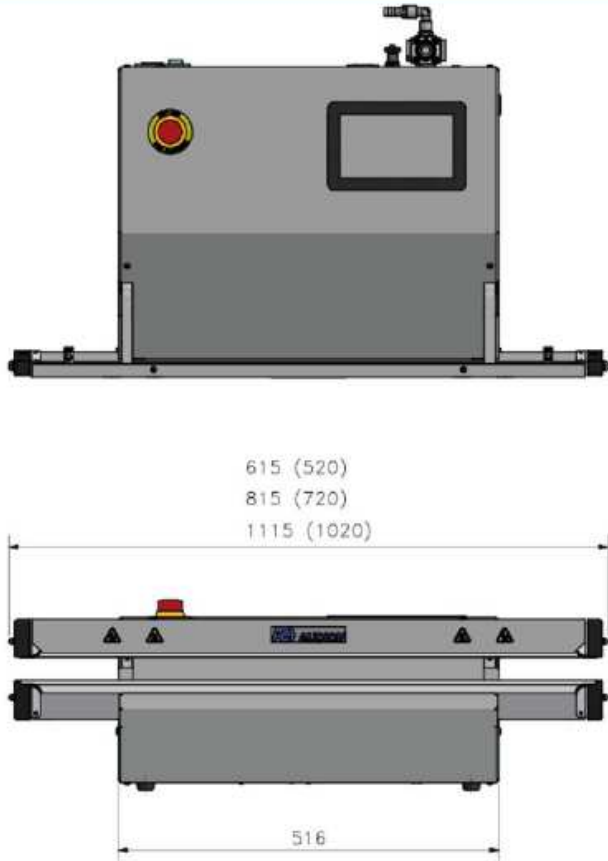

VAC PSR TC

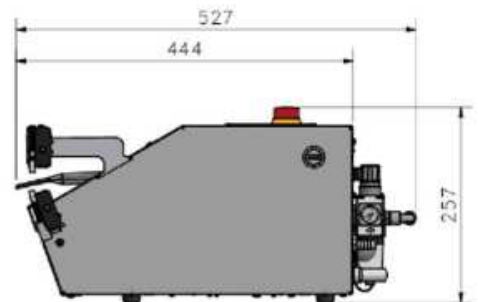
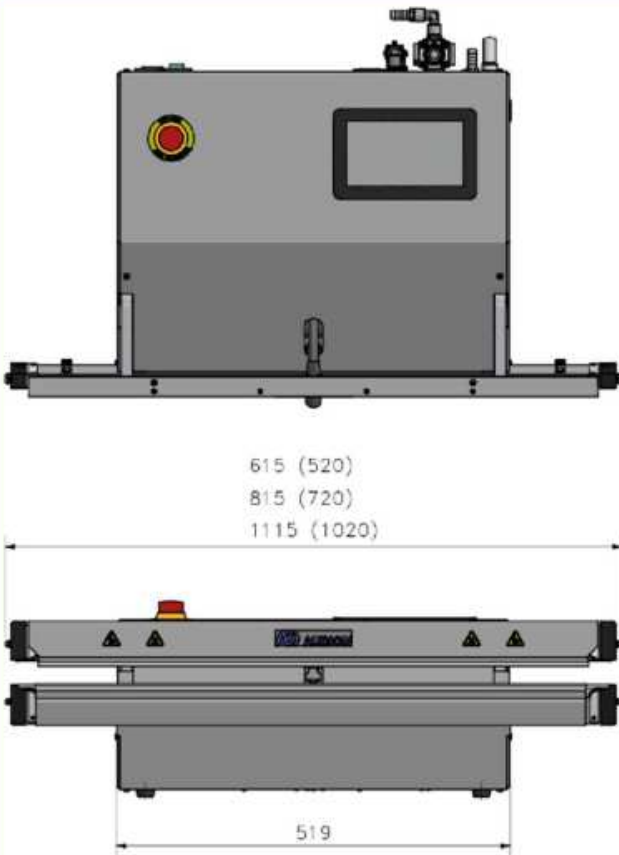

Technical specifications			
Recipe	Storage	50 recipes	
	Recipe backup (.bin file through USB stick)	Copy recipe to USB Load recipe from USB	
Process parameters	Vacuum time (*) Setting range	0.1 – 120.0 sec.	
	Gas flush time (*) Setting range	0.1 – 120.0 sec.	
	Seal temperature Setting range Tolerance range Accuracy	100 – 200 °C 0 – 20 °C (default 5 °C) +/- 3°C or +/- 2% (whichever is larger)	
	Seal time Setting range	0.8 – 10.0 sec.	
	Cooling temperature Setting range	50 – 150 °C	
Adjustable parameters	Fine tuning for calibration	Seal temperature	
Monitoring and recording functions	Parameter monitoring (alarm stop)	Seal temperature	
	Data logging (.csv file through USB stick)	Machine ID Login level Recipe name Batch number Parameter settings Temperature tolerance Alarm limits Date/time Seal ID Parameters results Pass/fail Alarm code	
System & functions	Login level	Operator Supervisor (password access) Administrator (password access)	
	Language	English German Italian Czech	Netherlands French Japanese Chinese
	Alarm history	Date/time Alarm code/descriptions	
	Counter	Bag counter (resettable) Machine counter (non-resettable) Batch counter (resettable)	

(\*) Only applicable to vacuum models

Options	Codes	Descriptions
Support	SP PSR	Support for 520 in stainless steel
	SP PSRWB	Support for 720 – 1020 in stainless steel
	SP WPW	White polyamide wheels for cleanroom for SP PSR (instead of the standard grey wheels)
	PSR1 RB	Roller conveyor in stainless steel for SP PSR Not available for SPM-CONF
	SPM-CONF	Motorized support in stainless steel for 720 -1020
Bag support	SPM WL EP	Wider legs to place the support legs around euro pallet Additional option for SPM-CONF
	BS PSR	Bag support in stainless steel for 520 -1020 Additional option for SP / SPM-CONF
Work table	BSPM	Motorized bag support in stainless steel for 720 -1020 Additional option for SPM-CONF
	OT PSR	Work table for 520 in stainless steel, attached to frame
Sealing wire	OT PSRWB	Work table for 720 in stainless steel, attached to frame
	5MM SW	5 mm seal (instead of 8 mm)
Cutting	CD 520	Cutting device
	CD 720	Available on 520 and 720 models Cutting length 440 mm (for both models)
Nozzles	WNOZ (*)	Wide vacuum nozzle (85 mm)
	ANOZ (*)	Adjustable nozzle in 2 positions (ENOZ included)
	PSRP_RNOZMODE (*)	Retracted nozzle mode
Vacuum	AHA (*)	Automatic height adjustment during vacuum The machine automatically descends during the vacuum process (vacuum height control)
	HVP (*)	20m3 Venturi pump
	EVP (*)	External Venturi pump (11m3 or 20m3)
	PES (*)	Particle ejection system
	VSF (*)	Vacuum skip function Finishes vacuum process when sensor setpoint is reached
	DVFR (*)	Digital vacuum flow regulator Reduction valve for controlling vacuuming speed
Filter	PF (*)	Powder filter, density 80 microns
	QCS (*)	Quick cleaning system for powder filter
	WS (*)	Water separator (liquid filter)
External air exhaust	PSR EXH COMPL (*)	Discharge of air outside of machine - External air exhaust from Venturi pump - External air exhaust from pneumatics (valves and cylinders)
	PSR EXH IST	Discharge of used compressed air outside of machine (valves and air cylinders)

Options	Codes	Descriptions
Bag stretching	BST 720	Bag stretchers for 720
	BST 1020	Bag stretchers for 1020
	BST A WNOZ	Adjustment for BST in combination with WNOZ (wide nozzle)
Foot pedal	PFP	Pneumatic foot operation
	FME S	Electrical foot operation with stainless steel protection cover
Start button	START	Start button on machine
Barcode scanner	BCSC	Quick recipe change by scanning a barcode Scanner : Honeywell Voyager 1400g
Labeller	LBL	For printing tracing information on labels and apply on bags Label printer : CAB MACH2
Software option	SW-UA	User admin (access control with login ID and password)
Special construction	FSS	Finger safety switch (additional safety sensors to provide extra finger protection)
	ESD	Electro-static discharge construction
	SILA	Silicone poor construction
	PSR_TFC	Thick film configuration
	115V	115V power supply
Power cable	PCUK	Power cable for UK
	PCCH	Power cable for Switzerland
	PCUS	Power cable for USA / Japan
	PCCN	Power cable for China

(\*) Only applicable to vacuum models

Accessories / Services	Codes	Descriptions
Parameter verification	ATM	Seal temperature verification set
Calibration	SERVKAL PSRTC AE	Audion factory calibration for seal temperature
Tests	FAT	Factory Acceptance Test conducted to determine if the CRS are met
	FSTP	In our factory, a test is performed with the customer's film(s) to program the machine with the most appropriate settings for optimal packaging quality and seal integrity

### Data logging file

AUDION ELEKTRO LOG FILE								
Machine ID:	1033515-02 ETO							
Username:	Operator							
Recipe:	TEST							
Batch:	ABC12345							
		Seal Time	Seal Temp	Cool Temp	Vac time1	Gas time1		
	Setpoint	1.5	125	80	3	3		
	TOL		5					
	UAL		130					
	LAL		120					
Date&Time [YYYY-MM-DD hh:mm:ss]	Seal ID	Seal Time	Seal Temp	Cool Temp	Vac time1	Gas time1	Pass/Fail	Alarm Code
2021/10/6 11:47	20	1.5	124.9	78	3	3	Pass	
2021/10/6 11:48	21	1.5	124.7	80	3	3	Pass	
2021/10/6 11:50	22	1.5	125	80	3	3	Pass	
2021/10/6 11:51	23	1.5	118	79	3	3	Fail	32

### Labeller



Type	VMS 333 VAL
Mach ID	ETD20055
Username	
Recipe	SEAL160
Batch nr.	InIt

Date (YY – MM – DD)	21 – 02 – 17
Time (HH:MM:SS)	11:08:29
Seal ID	15
Pass/Fail	Pass
Alarm nr.	

### Measuring instruments for parameter verification

#### Seal temperature



ATM

- Measurement range: -50°C to 260°C
- Resolution: 0,1°C (up to 199,9°C) / 1 °C (above 200°C)
- Accuracy display unit: 0.3% of reading + 1°C
- Accuracy sensor: +/- 2,2 °C or +/- 0,3% of measurement (whichever is larger)
- Measuring rate: 2,5 per second
- Minimum and maximum values readable
- Operating conditions: +5 ... 50 °C, 30 – 70% RH (non-condensing)
- Power supply: 9V battery
- Battery life: +/- 100 hours
- Dimensions: 63 (W) x 186mm (L) x 40mm (D)
- Weight: 350 grams